

Fensterbankkeil Miwo 040

Window sill wedge made of mineral wool for alsecco façade systems

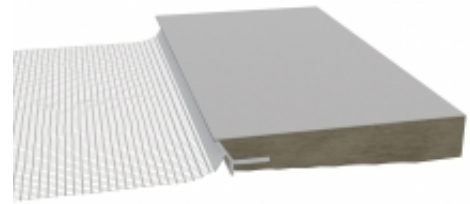

AREAS OF APPLICATION

Mineral wool insulation wedge with waterproof surface to form a second sealing level below the window sill.

PRODUCT PROPERTIES

- Custom-made element with project-specific projection and length
- With laminated sealing foil
- Integrated 5° gradient
- Integrated edge profile with mesh to create a clean render finish
- Rapid and easy installation to create a second sealing level

TECHNICAL DATA

Material	Mineral wool with laminated sealing foil
Fire behavior	Euroclass A1 to DIN EN 13501-1 for the insulation material
Rated value of thermal conductivity	0,040 W/(mK) (Insulation material)
Design	Height of front edge: ≥ 10 mm Slope: 5 degrees Projection: Cut to size up to 400 mm Length: Cut to size up to 3 m
Density	approx. 180 kg/m ³ (Insulation material)

APPLICATION INSTRUCTIONS

Substrate pre-treatment	All substrates must be sound, dry, even (DIN 18202 or 18203, as applicable), clean and free from adhesion-reducing residue. If necessary, pretreat substrates as specified in the application instructions for the adhesive.
Application	<p>The required length and depth / projection of the Fensterbankkeil Miwo 040 are determined on site. A suitable tool, e.g. Stanley knife, and a metal rule must be used to cut the unit to the exact size. To cut the plastic edge profile to length, use a suitable saw or profile shears.</p> <p>Before installing the Fensterbankkeil Miwo 040, ensure that the height of the last facade insulation panels in the connection/transition to the sill corresponds to the later installation situation (plus window sill wedge and window sill, minus the adhesive joint of approx. 2 - 5 mm).</p> <p>Cut the Fensterbankkeil Miwo 040 to the depth of the projection. Apply mineral adhesive (e.g. Armatop AKS) to the parapet or window sill wedge. Ensure that an adhesive contact area of at least 40 % is achieved between the Fensterbankkeil Miwo 040 and the substrate, as well as good edge adhesion. Bond the Fensterbankkeil Miwo 040 with a maximum adhesive bed of ≤ 5 mm. Align the Fensterbankkeil Miwo 040 so that the specified slope of the Fensterbankkeil Miwo 040 of 5° is maintained, if necessary take measures to secure the position.</p> <p>After sufficient drying of the Fensterbankkeil Miwo 040 and the previously completed reveal reinforcement, the window sealing foil Fensterdichtfolie ME 501 is first glued tightly to the frame and the reveal using window sealing foil adhesive Fensterdichtfolien-Kleber SP025. This is followed by the window sealing corner Fensterdichtecke konkav ME 540, which is glued overlapping to the window sealing foil Fensterdichtfolie ME 501 with window sealing foil adhesive Fensterdichtfolien-Kleber SP025 in the corner areas (see drawing). After application and drying of the finishing coat, the window sill is bonded to the finished sealing level with the window sill adhesive Fensterbankkleber SMART. The window sill is bonded at the waterproofing level with beads of adhesive (height approx. 8 mm, spaced approx. 200 mm apart) in the direction of drainage to the façade. We recommend the additional fitting of a joint sealing strip, e.g. Fugendichtband SMART 24/3 between the screw-on edge of the window sill and the window frame.</p> <p>Please note:</p> <p>If a second waterproofing level is created, window-sill holder cannot be installed. Once installed, the window sill must be supported and fixed so that the drainage level of the second waterproofing level is still effective. The gap to the drainage level should not be less than 4 mm to allow water droplets to roll off.</p>
Consumption	1 m/m

SKETCHES

Fensterbankkeil Miwo 040

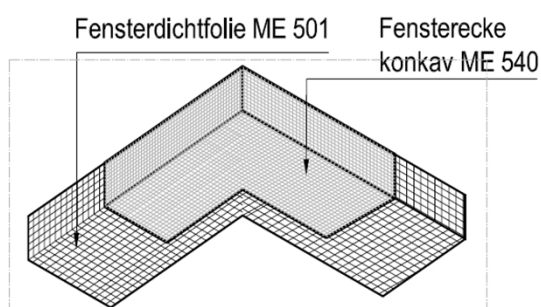
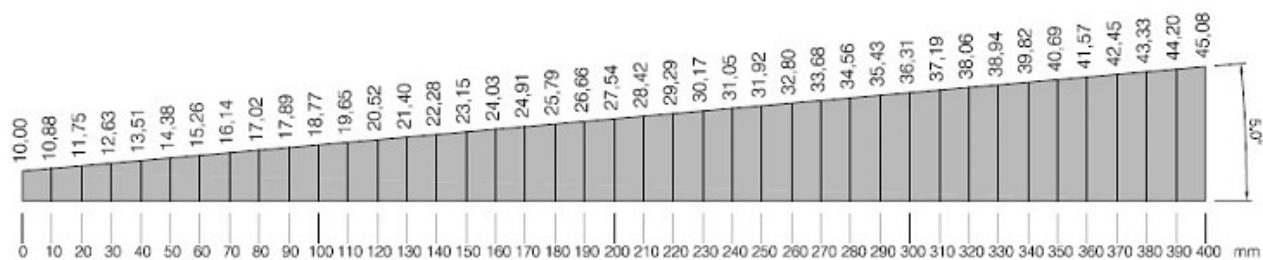

STORAGE

Dry, protected against moisture and sunlight.

PACKAGING INFORMATION

Colour	Mineral wool insulation
	Sealing foil: gray
Packaging unit	Project-specific delivery

OTHER INFORMATION

Transportation	Not a hazardous material
----------------	--------------------------

alsecco GmbH
 Kupferstraße 50
 D-36208 Wildeck
 Phone 03 69 22 / 88-0
 Fax 03 69 22 / 88-330
 Internet: www.alsecco.de

The above information is based on many years of experience and tests and is provided by us to the best of our knowledge. Such information applies in addition to our application guidelines. However, we cannot accept any responsibility for the correctness of our recommendations on account of wide variety of substrates and of on-site conditions and applications which are outside our control. Any recommendations provided by our employees and deviating from these documents must be given in writing. We reserve right to make any changes on account of technical progress or building regulations. Your technical advisor will be pleased to provide the relevant product data sheets.